



## SUPPLEMENTARY REGULATIONS

31 JANUARY-02 FEBRUARY 2020  
COVASNA-TRANSYLVANIA-ROMANIA

### 13. Winter Rally Covasna Metalubs

Organized by the  
Auto Crono Club



**RALLY WINNERS**

1	2007	BERARI CĂTĂLIN / HANGU FLORIN	RO/RO	MITSUBISHI EVO 6
2	2008	PESCARU IOAN / LAVRIC ANDRA	RO/RO	VW GOLF 2
3	2009	ONORIU DANIEL / TIURA GABI	RO/RO	MITSUBISHI EVO 8
4	2010	BERARI CĂTĂLIN / SANDU MIHAI	RO/RO	MITSUBISHI EVO 10
5	2011	PORCISTEANU VALENTIN / ALINA BUNICA	RO/RO	MITSUBISHI EVO 9
6	2012	SZABÓ GERGŐ / BORBÉLY KÁROLY	HU/RO	MITSUBISHI EVO 9
7	2013	SZABÓ GERGŐ / BORBÉLY KÁROLY	HU/RO	MITSUBISHI EVO 10
8	2015	TEMPESTINI SIMONE/PULPEA DORIN	I/RO	SUBARU IMPREZA
9	2016	HIDEG KRISZTIÁN / KERÉK ISTVÁN	HU/HU	MITSUBISHI EVO 9
10	2017	PORCISTEANU VALENTIN /DOBRE DAN	RO/RO	MITSUBISHI L. EVO 9
11	2018	KOVÁCS ANTAL / ISTOVICS GERGŐ	HU/HU	FORD FIESTA R5
12	2019	KOVÁCS ANTAL /ISTOVICS GERGŐ	HU/HU	FORD FIESTA R5

**CONTENTS:**

<b>1. INTRODUCTION</b>	<b>4</b>
<b>2. ORGANIZER</b>	<b>4</b>
<b>3. PROGRAMME</b>	<b>6</b>
<b>4. ENTIRES</b>	<b>7</b>
<b>5. INSURANCES</b>	<b>8</b>
<b>6. ADVERTISING AND IDENTIFICATION</b>	<b>9</b>
<b>7. TIRES</b>	<b>9</b>
<b>8. FUEL</b>	<b>9</b>
<b>9. RECONNAISSANCE</b>	<b>10</b>
<b>10. ADMINISTRATIVE CHECKS</b>	<b>10</b>
<b>11. SCRUTINEERING</b>	<b>11</b>
<b>12. OTHER PROCEDURES</b>	<b>11</b>
<b>13. PRIZES</b>	<b>14</b>
<b>14. FINAL CHECKS</b>	<b>14</b>

**APPENDIX 1 ITINERARY / GENERAL MAP**

**APPENDIX 2 RECONNAISSANCE SCHEDULE**

**APPENDIX 3 COMPETITORS RELATIONS OFFICERS**

**APPENDIX 4 COMPETITION NRS& ADVERTISING**

**APPENDIX 5 OVERALLS, HELMETS EXTRACTS FROM FIA APPENDIX L**

**APPENDIX 6 EMPTYING THE TANK AND/OR REFILLING IN THE SERVICE PARK**

**APPENDIX 7 SIZE REQUIREMENTS FOR THE RALLY STUDS**

**APPENDIX 8 SERVICE PARK LOCATION**

**APPENDIX 9 SHAKEDOWN DECLARATION**

**APPENDIX 9 GENERAL MAP**

**APPENDIX 10 SS MAP**

## 1. INTRODUCTION

**Covasna Rally Winte Metalubsr** – will be run in compliance with the FIA International Sporting Code and its appendices, the National Sporting Regulations which comply with the FIA regulations and these Supplementary Regulations.

Modifications, Amendments and/or changes to these Supplementary Regulations will be announced only by numbered and dated Bulletins (issued by the organiser or the Stewards).

### 1.1 ROAD SURFACE

1.2 Running surface of special stages: 100% snow and ice.

1.3 Special stages distance and total distance of the rally:

Distance of the itinerary:	144,20 km
The number of special Stages:	8
The overall SS distance:	98,50 km
Percent special stages of the itinerary	68,31 %
The number of sections:	4
The number of Leg:	3

## 2. ORGANIZER

**2.1** Titles for which the rally counts:

Winter Rally Covasna- this event is not included in the national calendar

Allowed to participate crews coming from other countries.

Event organized under the aegis of FRAS

### 2.2 VISA NUMBERS

Organiser License FRAS nr.

### 2.3 ORGANISER'S NAME

#### CLUB AUTO CRONO

##### 2.3.1 Address and contact details – Permanent Office

Romania, 520031 Sf. Gheorghe, Livezii Street, Nr. 3

Mobile: +40740-944-841

E-mail: [autocrono@gmail.com](mailto:autocrono@gmail.com)

Official Web Site of the organizer: [www.autocrono.ro](http://www.autocrono.ro)

### 2.4 ORGANISATION COMMITTEE

Gyerő József  
Kocsis Béla  
Ciocirlan Mihai  
Domaházi János  
Simon Árpád

## 2.5 STEWARDS OF THE MEETING

Chairman of stewards – OROS LAURENTIU

Steward – SIMON ÁRPÁD

Steward – MIHALY ANTAL

## 2.6 OFFICIALS

Clerk of the Course	BENEDEK SANDOR	Telefon:+40723362381 - benedek@elmas.ro
Secretary of the Rally	OROS MIMI	
Administrative Checks Secretary	SIMON EDIT	
Competitors Relations Officer	SZABO CSONGOR	
Chief Timing & Route Officer	IONUTI HADAR	
Chief Safety Officer	BADIU IOAN	
Chief Sweeping Car	MIHALY ANTAL	

## 2.7 HEADQUARTERS (Rally office from Wednesday, January 29)

**Location:** Locatia: 525200, Covasna, Hotel Caprioara, 1 Decembrie 1918 Street, Nr.1-2

## 2.8 LOCATION OF MEDIA CENTER AND PRESS ROOMS

Covasna, Hotel Caprioara

## 2.9 OFFICIAL NOTICE BOARD LOCATION

Covasna, Hotel Caprioara

## 2.10 LOCATION OF OVERNIGHT PARC FERMÉ

Covasna, Hotel Caprioara

### 3. PROGRAMME

#### SCHEDULE BEFORE THE RALLY WEEK

<b>WED 15 JAN 2020</b>	-Supplementary regulations and entry form published	Website
<b>MON 27 JAN 2020</b>	-Closing date for entires and publication of List of Entires	Website

#### SCHEDULE DURING THE RALLY WEEK

##### WED 29 JAN

10:00-18:00	- Reconnaissance registration/Collection of Material & Documents	Hotel Caprioara Covasna
10:00-17:00	- Reconnaissance	According to Schedule

##### THU 30 JAN

10:00-18:00	- Reconnaissance registration/Collection of Material & Documents	Hotel Caprioara Covasa
07:00-17:00	- Reconnaissance	According to Schedule

##### FRI 31 JAN

08:00-10:30	- Reconnaissance registration/Collection of Material & Documents	Hotel Caprioara Covasa
08:00-13:00	- Reconnaissance	According to Schedule
09:00-13:00	- Shakedown	Comandau
11:00-16:00	- Opening Administrative Checks	Hotel Caprioara Covasna
11:30-16:30	- Scrutineering	Parking Hotel Caprioara Covasna
11:30-20:00	- Opening of Media Center and Accreditation	Hotel Caprioara Covasna
17:00	- Start SS	Covasna center
20:00	- First Stewards Meeting	Rally HQ
20:30	- Publication of the start list for Leg 1	Rally HQ

##### SAT 01 FEB

07:00	- Opening of the service park	Comandau
08:00-22:00	- Opening of the Rally Secretariat	Pension Eden Comandau
09:00	- Start of leg 1	TC SS2 COVASNA
22:00	- Publication of the start list for Leg 2	Rally HQ

##### SUN 02 FEB

07:00	- Opening of the service park	Comandau
08:00-15:00	- Opening of the Rally Secretariat	Pension Eden Comandau
09:00	- Start Leg 2	OUT of the Parc Service Comandau
12:20	- Finish of the rally- first car	Park Service IN Comandau
13:30	- Final Stewards Meeting	Rally HQ
14:30	- Publication of the Provisional Classification	Rally HQ
15:00	- Prize-Giving	Hotel Caprioara Covasna
15:30	- Post-event press conference	Hotel Caprioara Covasna

## 4 ENTIRES

### 4.1 ENTRY PROCEDURE

Entry form must be sent by e-mail to [autocrono@gmail.com](mailto:autocrono@gmail.com).

The entry form must be accompanied by a crew has a 4x4cm photos and at least one photo of the entered car.

### 4.3 NUMBER OF ENTRANTS ACCEPTED AND CLASSES

**4.3.1** The maximum number of entrants is fixed to **40**

The organizer's selection will be the following:

- FRAS pilot license
- Pilots other countries
- Unlicensed pilots with recommendation from a sports club

### 4.3.2 THE GROUP AND CLASSES OF ELIGIBLE CARS WILL BE DIVIDED AS FOLLOWS:

According art. . 4.2, 4.3 și 4.4 National Sporting Regulations 2019

Clasa	Grupa
2	S2000-Rally: 1.6 Turbo engine with 30 mm restrictor S2000-Rally S2000-Rally: 2.0 Atmospheric Group R4 Group R5
3	N Group; automobiles with over 200 ccm cylinder (former N4) N+ Group national homologation
4	RGT
5/6 RC3	Group A – over 1600 ccm and no more than 2000 ccm Super 1600 R2C (over 1600 ccm until 2000 ccm – VR2C and turbo over 1067 ccm until 1333 ccm – VRC2) R3 (over 1600 ccm until 2000 ccm – VR3C and turbo over 1067 ccm until 1333 ccm – VRC3) R3T (turbo, up to 1620 ccm /rated displacement VR3T) R3D (diesel, up to 2000 ccm /rated displacement VR3D)
7/8 RC4	Group A – no more than 1600 ccm R2 (over 1390 ccm up to 1600 ccm- VR2B and turbo over 927 ccm up to 1067 ccm – VR2B) Kit-car up to 1600 ccm Group N - automobiles with over 1600 ccm cylinder until 2000 ccm.
9/10 RC5	Group N - automobiles with the cylinder up to 1600 ccm R1 (up to 1600 ccm – VR1A/VR1B and turbo up to 1067 ccm – VR1A/VR1B) R1A (up to 1400 ccm)
11	Group H - 4WD
12	Group H - 2WD
13	Grupa I – historic automobiles

### 4.4 ENTRY FEE

**4.4.1** The entry fee could be paid in the same time with registration for

#### 4.4.2

Entry Fee/Crew:310 euro

Entry Fee Shakedown:60 euro

Crew insurance: 30 euro

Note: Payment by reconnaissance registration

#### 4.4.3. Refunds

Entry fee will be refund :

- 100% to the crews/teams in case the rally doesn't take place;
- 100% to the crews who don't pass the administrative checking;
- 50 %, to those crews/teams who can't start in the race of force majeure reasons

#### 4.4.4 REGISTRATION PACKAGES

Items	
<b>Documentation</b>	
Supplementary Regulations	Website
Road- Book	1
Rally Guide	Website
Individual Passes	2
<b>Vehicle Plates</b>	
Rally Plates	2
Reconnaissance nubers	2
<b>Other</b>	
Service Park available space	40 sm
Electricity	NO
Waste oil and garbage collection	YES

## 5. INSURANCES

The competitors will be insured on all special stages by an insurance of civil liability against all third party risks of 50.000 Lei indemnity, made by the organizer.

**5.1** The insurance cover will come into effect from scrutineering and will cease at the end of the event or at the moment of retirement, disqualification or exclusion.

**5.2** Crews participating in the rally must have valid insurance covering them for personal injuries (personal accident insurance including death and disablement).

#### **5.3 ACCIDENTS IN ROUTE LIASON PROCEDURE**

In case of an accident, in the route liaison, the competitor or his representative must notify in writing the Clerk of the Course in as short a time as possible and in a maximum of 3 hours. He must explain the circumstances under which the accident occurred.

Likewise he must mention the names and addresses of any witnesses.

**5.4** The service vehicles, even those bearing the plates "Service" issued by the organizer maynever be considered as official participants in the rally. They are therefore not covered by the insurance policy of the rally and remain the sole responsibility of their owners.It's the same for the cars used by the competitors for the reconnaissance.

In any circumstances, for any car event, incident or accident total liability belongs to the persons driving at the time and for any reason they will not involve in any way Crono Auto Club, Organizing Committee, FRAS officials or anyone in the organization this event. Also any compensation requested is unfounded.

## 6. ADVERTISING AND IDENTIFICATION

The Organiser will provide each crew with the Rally Plates, Compulsory Advertising which must be affixed to their car prior to Scrutineering

### 6.1 ADVERTISING

#### 6.1.1 COMPULSORY

#### COVASNA WINTER RALLY METALUBS

### 6.2. COMPETITION NUMBERS

According appendix 4

## 7. TIRES

**7.1** Are admitted only competition vehicles equipped with studded tires.

**7.2** Every car is allowed to transport on board maximum two spare wheels securely fixed

**7.3** Size requirements for the rally studs in according to Appendix 7 of this Regulation.

**7.4.** Tires for reconnaissance

**Using of studded tyres forbidden.**

Tyres on reconnaissance cars will be winter tyres.

## 8. FUEL

### 8.1 GENERAL

**8.1.1** Crews may refuel zone only designated in the road book

**8.1.2** In the refueling are allowed two team members. They are required to wear badge (service) and reflective vest. Also their equipment must be specific to such operations.

**8.1.3** In the event of a breakdown, the car concerned may be pushed out of the zone by the crew, officials and/or the two team members without incurring a penalty.

### 8.2 PROCEDURES

**8.2.1** Only actions inside a RZ directly involved in the refuelling of the competing vehicle are permitted.

**8.2.2** In all RZ's , a 5 km/h speed limit will apply

**8.2.3** Engines must be switched off throughout the refuelling operation.

**8.2.4** It is recommended that the crew stay outside the car during refuelling; however, if they remain inside, their safety seat belts must be unfastened.

### 8.2 PERSONNAL PROTECTIVE EQUIPMENT (EPP)

**8.2.1** Team members assisting during refuelling, should wear industry homologated PPE for hydrocarbons handling, such as safety glasses, protective rubber gloves, safety shoes and anti-static clothing.

**8.2.2** It is highly recommended that the team members to wear fire-resistant clothing.

## 9. RECONNAISSANCE

### 9.1 REGISTRATION

Location Rally HQ

All competitors who wish to take part in reconnaissance must register at Rally Headquarters to get all the necessary documentation before starting, according to The Programme schedule.

**9.1 .2** Organiser will supply 2 stickers that must be affixed on the windshields (co-driver's side), One on the front, and other on the rear of the reconnaissance car. These must be visible for the duration of the reconnaissance period.

### 9.1 .3 PROGRAMME

Reconnaissance will be held in according to Appendix 2 of this Regulation.

### 9.2 SPECIFIC RESTRICTIONS AND SPEED LIMITS

Crews are authorized to drive a maximum of 2 (two) passages through each special stage  
On the special stages speed limit is **40 km / h**

Exceeding the speed limit on the special stages organizer will be sanctioned by the refusal start competition.

Violation of the reconnaissance schedule and rules will attract the interdiction to participate at the rally.

**9.2.1** The presence of a driver and/or his co-driver on a special stage, in any way whatsoever, is considered as reconnaissance.

### 9.3 SPEED CONTROL

Speed will be monitored by GPS. In the central area of the town Covasna speed limits are 40 km/h

### 9.4 RECONNAISSANCE CARS

In accordance with Article 25.1 of the FIA

### 9.5 TIRES FOR RECONNAISSANCE CARS

**It is forbidden to use tires with nails.**

Tires used for reconnaissance cars are winter tires.

## 10. ADMINISTRATIVE CHECKS

### 10.1 Original documents to be presented By each competitor:

- Driver and Co-driver competition licenses or recommendation from a sports club
- Driver and Co-driver passports or identification
- Driver and Co-driver valid driving licenses
- Rally car's (registration and property)
- Car Owner authorisation to participate in the rally (If the owner is not the Competitor/driver)
- Rally car's Insurance cover certificate

#### 10.1.1 Location

Rally Headquarters  
Covasna, Hotel Caprioara

## 11. SCRUTINEERING SEALING AND MARKING

### 11.1 Location

Rally Headquarters  
Covasna, Hotel Caprioara Park Ferme

### 11.2

Race car could be presented by the crew or member of the team  
The rally plates and compulsory advertising will be affixed.  
Maximal noise level can't exceed 100 dB at 5000rpm for petrol engine and 2500rpm for diesel engine  
The crew will show the complete protection equipment, first aid and reflective triangle  
The race car technical passport and roll cage documents.

## 12. OTHER PROCEDURES

### 12.1.1. OFFICIAL PRESENTATION AND CEREMONIAL START

There will be Covasna downtown

### 12.1.2 Emergency numbers

**EMERGENCY NUMBER OF THE WINTER RALLY**

**0723 362 381**

### 12.1.3. PARK FERME

Friday, 2020 January 31, parking Hotel Caprioara, mandatory attendance until 11:00

### 12.1.4. START OF THE RALLY

Friday	31 January	17:00	Ceremonial start, the center of Covasna
Saturday	01 February	09:05	Covasna TC SS2
Sunday	03 February	09:00	Comandau, Park service Out

### 12.1.5. START INTERVALS

The start interval will be of 1 minute for all drivers.

### 12.1.6. START ORDER

The start order for the start of the rally end second day two will be prepared by the Stewards

The start order for day third is provisional overall standings after the first day.

### 12.1.7. STARTING SYSTEM OF SPECIAL STAGES

An analogical clock will be present at the start of every stage. This clock will show hours, minutes and seconds and will be connected to the start detection equipment. The clock will function normally up until the full minute. After the crew starts, the clock will remain blocked, displaying the hour, minute and second start time for 7 seconds.

**12.1.8.** In case the electronic start system fails, the start will be given as specified in the article 26.3 of Regulation National Rally Championship

## **12.2. FINISH PROCEDURE**

### **12.3. PERMITTED EARLY CHECK-IN**

CO 6A (service IN)  
CO 8A (service IN)

### **12.4. SUPER SPECIAL STAGES PROCEDURES**

#### **12.4.1. Locatia**

Covasna center

#### **12.4.2. Characteristics**

Length: 1,3 km

Runing surface: frozen asphalt/snow

#### **12.4.3. Course**

- Stage time don't be add to the overall ranking

- Taking part on special stage is mandatory (connected to the crew presentation)

Skipping participation will come with 7 minutes' penalty added to the general ranking time.

#### **12.4.4. Start in superstake on the official indication**

#### **12.4.5 Tyres**

Studded tyres forbidden, winter tyres will be used

### **12.5. TIME CARD CHANGE DURING THE RALLY**

Time cards will be issued at the following time controls: CO 0,1A,1B,6C,6D,8C

### **12.6. OFFICIAL TIME USED DURING THE RALLY**

Throughout the rally, the official time will be UTC + local offset.

### **12.7. RESTART AFTER ABANDONMENT day 2 & 3(Superally)**

#### **12.7.1. INFORMATION AND INTENTION TO RETURN**

Any crew that failed to complete day one can re-start the rally on Day 2 ore 3 only if the intention to confirm the Clerk an hour before the start of publication of the list for Day 2.

**12.7.2.** With an hour before the start of the first competitor at next section, the crew must present the vehicle to the Scrutineers

**17.7.3.** Each failed special stage wil result 5 min penalty added to the weakest time on the stages in the same class, including the abandonad stage.

### **12.8. EXCESSIVE SPEED DURING THE RALLY (Liaison routes)**

During the rally, crews must respect traffic laws. Any crew who does not comply, will be excluded.

### **12.9 SHAKEDOWN**

#### **12.9.1 PARTICIPANTS**

Crews have requested registration in shakedown.

The competitors and their invitations who participate in shakedown are required to wear safety equipment (overall, helmet, etc.).

Failure of this Article result in exclusion from the test session.

All persons invited by the crews to take part on the shakedown, must fulfill statement of responsibility, according Apendix VIII, and hand over at stage start.

### 12.9.2 LOCATION

Comandau to be communicated one day before the race

### 12.9.3 TECHNICAL DATA

3km length, which will go round trip

### 12.9.4. Program

Friday, Februarie 2, between 09:00-13:00

## 12.11. SERVICE PARK

### 12.11.1. Location

- Saturday Comandau, Pension Katinka, specified in Road Book
- Sunday Comandau, Pension Katinka, specificat in Road Book

### 12.11.2. OPENING OF SERVICE PARK

Access schedule for Service Vehicles:

Saturday, 01 February between: 07:00-22:00

Sunday 02 February between: 07:00-18:00.

### 12.11.3 POSITIONING PLACE IN SERVICE PARK

Crews place in the service park is realized according to the layout elaborate by the organizer. Every crew will be allocated 40 mp.

### 12.11.4 SPEED IN THE SERVICE PARK

The maximum speed allowed in the service park is 15 km/h

Failure to comply with this limit shall result excluding the crew

### 12.11.5. VEHICLES ALLOWED IN SERVICE PARKS

Only one service vehicle per competing car starting the rally is allowed inside the Service Park throughout the rally. These vehicles must be clearly identified by means of "Service" plate issued by the Organisers and affixed on the front windscreen.

### 12.11.6. SERVICE PARK RULES

#### Cleanliness and safety of your stand

Each competitor is responsible for the behavior of its service team members. In the service park, all competitors must:

- keep near to any racing car a fire extinguisher for A, B, and C type fires of a minimum capacity of 5 kg, having been checked within the last 2 years.
- place under each racing car a waterproof and resistant to hydrocarbons ground sheet of a surface equal to that of the car ( 3 x 5 m minimum).
- waste-disposal in places other than those intended

**Oil, waste water emptying, car wash and staking out on the ground are forbidden in the Service Parks.**

## 13. PRIZES

**13.1.** Prize-giving will take place at the Hotel Caprioara

### **13.2. CLASSIFICATION**

Will be awarded the following top three classifications:

- overall classifications
- classes classification
- special awards rear wheel drive
- Dacia Cup classification

## 14. PROTEST

Any protest/appeal must be according the regulation. The crews that participated, but abandoned can also appeal. Any appeal must be written and sent to the Clerk of the Course.

**14.1.** The limit date of ranking protests is maximum 30 minutes after issuing the official results.

## APPENDIX 1

## ITINERARY

13th WINTER RALLY COVASNA 31 JANUARY - 02 FEBRUARY 2020	
SHAKEDOWN	FRIDAY 31 JANUARY 2020
Shakedown Comandau	09:00-13:00

Sunrise - 07:39 / Sunset - 17:19

START LEG 1		ITINERARY			FRIDAY 31 JANUARY 2020		
TC/SS/RZ CO/PS/ZA	LOCATION / LOCATIE	SS. Dist. PS km	Liaison dist Dist Partiala	TOTAL dist	Target Time Timp etapa	Average speed Viteza medie	First car due Prima masina
0	PARC FERME OUT COVASNA						17:00
1	COVASNA -CENTRU		0.20	0.20	0:10	1.20	17:10
	SS	1.30			0:03		17:13
SECTION 1		1.30	0.30	1.50	86.67%		0:13

Sunrise - 07:38 / Sunset - 17:20

START LEG 2		ITINERARY			SATURDAY 01 FEBRUARY 2020		
TC/SS/RZ CO/PS/ZA	LOCATION / LOCATIE	SS. Dist. PS km	Liaison dist Dist Partiala	TOTAL dist	Target Time Timp etapa	Average speed Viteza medie	First car due Prima masina
2	COVASNA COMANDĂU	11.60			0:03		9:00 9:03
2A	Service A IN		1.60	13.20	0:25	31.68	9:28
SERVICE A COMANDAU		11.60	1.60	13.20	0:30		
2B	SERVICE A OUT						9:58
Z/RZ 1	Refuel / Alimentare Distance to next refueling Distanta urmatoarea alimentare	29.60	16.60	46.20			
3	COMANDĂU MICA SIRIU	20.60	2.20	2.20	0:10 0:03	13.20	10:08 10:11
4	BETASU KORPAŞ 1	9.00	12.20	32.80	0:59 0:03	33.36	11:10 11:13
4A	SERVICE B IN		2.20	11.20	0:25	26.88	11:38
SERVICE B COMANDAU		29.60	16.60	46.20	0:45		
4B	SERVICE B OUT						12:23
Z/RZ 2	Refuel / Alimentare Distance to next refueling Distanta urmatoarea alimentare	26.00	20.20	46.20			
5	COMANDĂU TRANSYLVANIA HUNTER CIRESU	17.00	2.20	2.20	0:10 0:03	13.20	12:33 12:36
6	CIRESU KORPAŞ 2	9.00	15.80	32.80	0:59 0:03	33.36	13:35 13:38
6A	SERVICE C IN		2.20	11.20	0:25	26.88	14:03
SECTION 2		67.20	38.40	105.60	63.64%		5:03

Sunrise - 07:37 / Sunset - 17:22

START LEG 3		ITINERARY			SUNDAY 02 FEBRUARY 2020			
TC/SS/RZ CO/PS/ZA	LOCATION / LOCATIE	SS. Dist. PS km	Liaison dist Dist Partiala	TOTAL dist	Target Time Timp etapa	Average speed Viteza medie	First car due Prima masina	
6B	SERVICE C OUT COMANDAU						9:00	
ZARZ 3	Refuel / Alimentare Distance to next refueling Distanta urmatoarea alimentare	30.00	7.00	37.00				Section 3
7	COMANDĂU		2.40	2.40	0:07	20.57	9:07	
	MANISCA	15.00			0:03		9:10	
7A	Regroup A IN		1.20	16.20	0:40	24.30	9:50	
	<b>REGROUPING A</b>				<b>1:30</b>			
7B	Regroup A OUT						11:20	
8	MANISCA		1.00	1.00	0:07	8.57	11:27	Section 4
	PĂRĂUL HALOM	15.00			0:03		11:30	
8A	SERVICE D IN - RALLY FINISH		2.40	17.40	0:50	20.88	12:20	
	<b>SECTION 3&amp;4 totals</b>	<b>30.00</b>	<b>7.00</b>	<b>37.00</b>	<b>81.08%</b>		<b>3:20</b>	

TOTALS OF THE RALLY				
	SS	Liaison	Total	SS %
FRIDAY -SECTIONS 1= 1 SS	1.30	0.30	1.60	81.25%
SATURDAY -SECTIONS 2= 5 SS	67.20	38.40	105.60	63.64%
SUNDAY -SECTIONS 3&4= 2 SS	30.00	7.00	37.00	81.08%
TOTAL: 8 SS	98.50	45.70	144.20	68.31%

## APPENDIX 2

## RECONNAISSANCE SCHEDULE

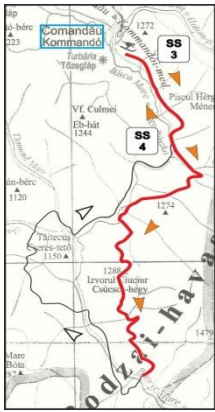
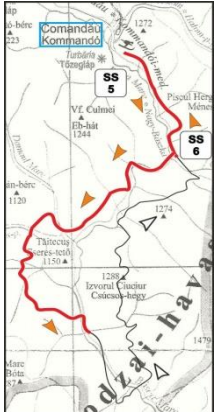
Day / Date	Schedule	Special Stage	Roads	
Ziua/Data	Interval Orar	Proba Speciala	Drumuri	
Wednesday / Thursday Miercuri / Joi  2020 January 29/30	10:00-16:00	2 COMANDAU	Covasna - Comandau  2 passes/2 treceri	
Friday Vineri  2020 January 31	08:00-13:00	2 COMANDAU	Covasna - Comandau  2 passes/2 treceri	
Wednesday Miercuri  2020 January 29	departure in group plecare in grup  09:00-09:15 11:00-11:15	3 MICA SIRIU  4 KORPAS 1	Comandau – Mica Siriu – Korpas 1  2 passes/2 treceri	
Thursday Joi  2020 January 30	departure in group plecare in grup  13:00-13:15 15:00-15:15	5 T.H. CIRESU  6 KORPAS 2	Comandau – Ciresu – Korpas 2  2 passes/2 treceri	
	departure in group plecare in grup	3 MICA SIRIU  4 KORPAS 1	Comandau – Mica Siriu – Korpas 1  1 passes/1 treceri	

<b>Friday</b> <b>2020 January 31</b>	<b>09:00-09:15</b>			
	departure in group plecarea in grup <b>11:00-11:15</b>	<b>5</b> <b>T.H. CIRESU</b> <b>6</b> <b>KORPAS 2</b>	<b>Comandau – Ciresu – Korpas 2</b> <b>1 passes/1 treceri</b>	
<b>Wednesday / Thursday</b> <b>Miercuri / Joi</b>  <b>2020 January 29/30</b>	departure in group plecarea in grup <b>09:00-09:15</b> <b>11:00-11:15</b> <b>13:00-13:15</b> <b>15:00-15:15</b>	<b>7</b> <b>MANISCA</b> <b>8</b> <b>PARAUL HALOM</b>	<b>Comandau – Manisca – Paraul Halom</b>  <b>2 passes/2 treceri</b>	
<b>Friday</b> <b>2020 January 31</b>	departure in group plecarea in grup <b>09:00-09:15</b> <b>11:00-11:15</b>	<b>7</b> <b>MANISCA</b> <b>8</b> <b>PARAUL HALOM</b>	<b>Comandau – Manisca – Paraul Halom</b>  <b>2 passes/2 treceri</b>	
<b>Wednesday / Thursday</b> <b>Miercuri / Joi</b>  <b>2020 January 29/30</b>	<b>09:00-16:00</b>	<b>1</b> <b>SS</b>	<b>Super Stage reconnaissance will be done by the crews walking, without car</b>  <b>Recunoasterea Superspecialei se face pe jos</b>	

**APPENDIX 3**

**COMPETITORS RELATIONS OFFICER**



**SZABO CSONGOR**

TEL: +40 722 298 080

## APPENDIX 4

## COMPETITION NRS&amp; ADVERTISING

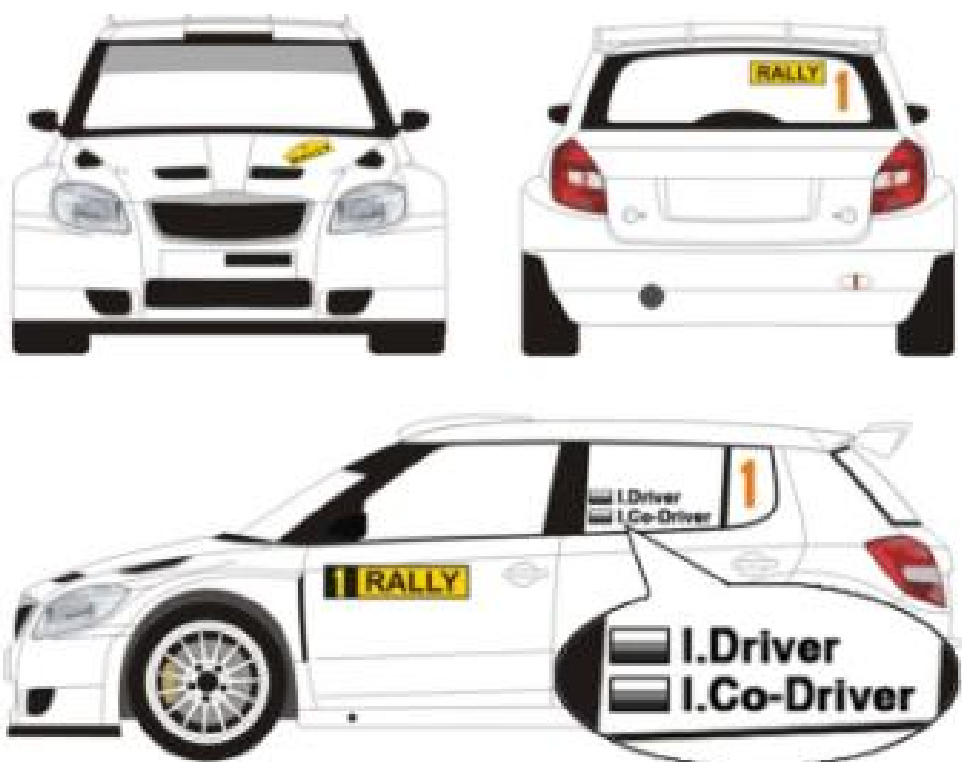

**(1) DOOR PANELS** - Two front door panels measuring 67 cm wide by 17 cm high including a 1 cm white surround. Each of these panels shall comprise a matt black competition number box which shall always be at the front of the panel. Numerals will be fluorescent yellow (PMS 803), 14 cm high and with a stroke width of 2 cm. The remainder of this door panel is reserved for the organiser. Each panel shall be placed horizontally at the leading edge of each front door with the number at the front. The top of the panel shall be between 7 cm and 10 cm below the lower limit of the window.

**(2) SIDE WINDOWS** - Numbers for each rear side window, coloured fluorescent orange (20 cm high). These numbers shall be placed at the top of the rear side windows adjacent to the crew's name.

**(3) REAR WINDOW** - One rear window panel measuring a maximum of 30 cm wide and 10 cm high shall be positioned at the rear window, and centred. An adjacent area of 15 cm<sup>2</sup> shall contain the fluorescent orange 14 cm high competition number on a clear background.

**(4) FRONT PLATE** - One plate fitting into a rectangle 43 cm wide by 21,5 cm high which include the competition number.

**(5) ROOF PANEL** - One roof panel, 50 cm wide by 52 cm high, to be placed on the roof with the top towards the front of the car.

**(6) COMPULSORY ADVERTISING** - Plates measuring 67 cm wide by 19 cm high, placed horizontally, under the panel (1).

**APPENDIX 5****OVERALLS, HELMETS EXTRACTS FROM FIA  
APPENDIX L****OVERALLS****Flame-resistant clothing**

All drivers and co-drivers must wear overalls as well as gloves (optional for co-drivers), long underwear, a balaclava, socks and shoes homologated to the FIA 8856-2000 standard (Technical List N°27).

Users must ensure that garments are not too tight, as this reduces the level of protection.

Embroidery sewn directly onto the overalls shall be stitched onto the outermost layer only, for better heat insulation. Backing material of badges and thread used for affixing them to the overalls must be flameproof (see Appendix 1 of the FIA 8856-2000 Standard for detailed requirements and instructions for use).

**Helmets**

Helmets homologated to one of the standards listed in FIA Technical List N° 25.

**APPENDIX 6****EMPTYING THE TANK AND/OR REFILLING  
IN THE SERVICE PARK**

When necessary as part of service (i.e. changing a fuel tank or pump), emptying and/or refilling is permitted in a service park provided that:

- The work is carried out with the knowledge of the Organizer and under a supervision of a Park Officer.
- No other work is carried out on the car during the emptying and/or refilling operation.
- A suitable safety perimeter is established around the car.
- Only sufficient fuel is added to each the next refuel zone.
- 2 Marshals are in stand-by with flammable liquid Fire extinguishers.

## APPENDIX 7

## SIZE REQUIREMENTS FOR RALLY STUDS

WINTER RALLY- SIZE REQUIREMENTS FOR THE RALLY STUDS

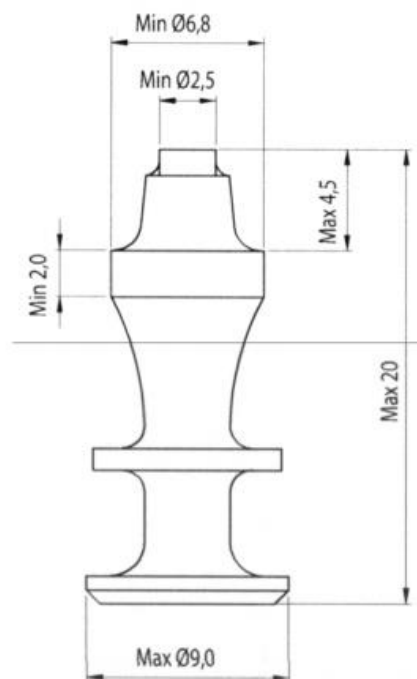

**Note:** dimensions in drawing are indicated in millimetres.

**Studded racing tyres must conform to the following**

- studs must be solid, have cylindrical shape and be flatly chopped;
- cross-section of the studs be in full circular shape at any place of the stud;
- stud must not be tubular at any place of the stud;
- stud block must be solid, inner holes or tubes are not allowed;
- maximum diameter of the stud sole is 9 mm;
- minimum diameter of the metal stud core is 2.5 mm. Core must be solid, have cylindrical shape and be flatly chopped;
- studs must not be longer than 20 mm;
- maximum weight of the stud is 4 grams;
- studs must be mounted on the outside of the tyre;
- maximum number of the studs must not exceed 20 units at any decimetre of wheel circumference.

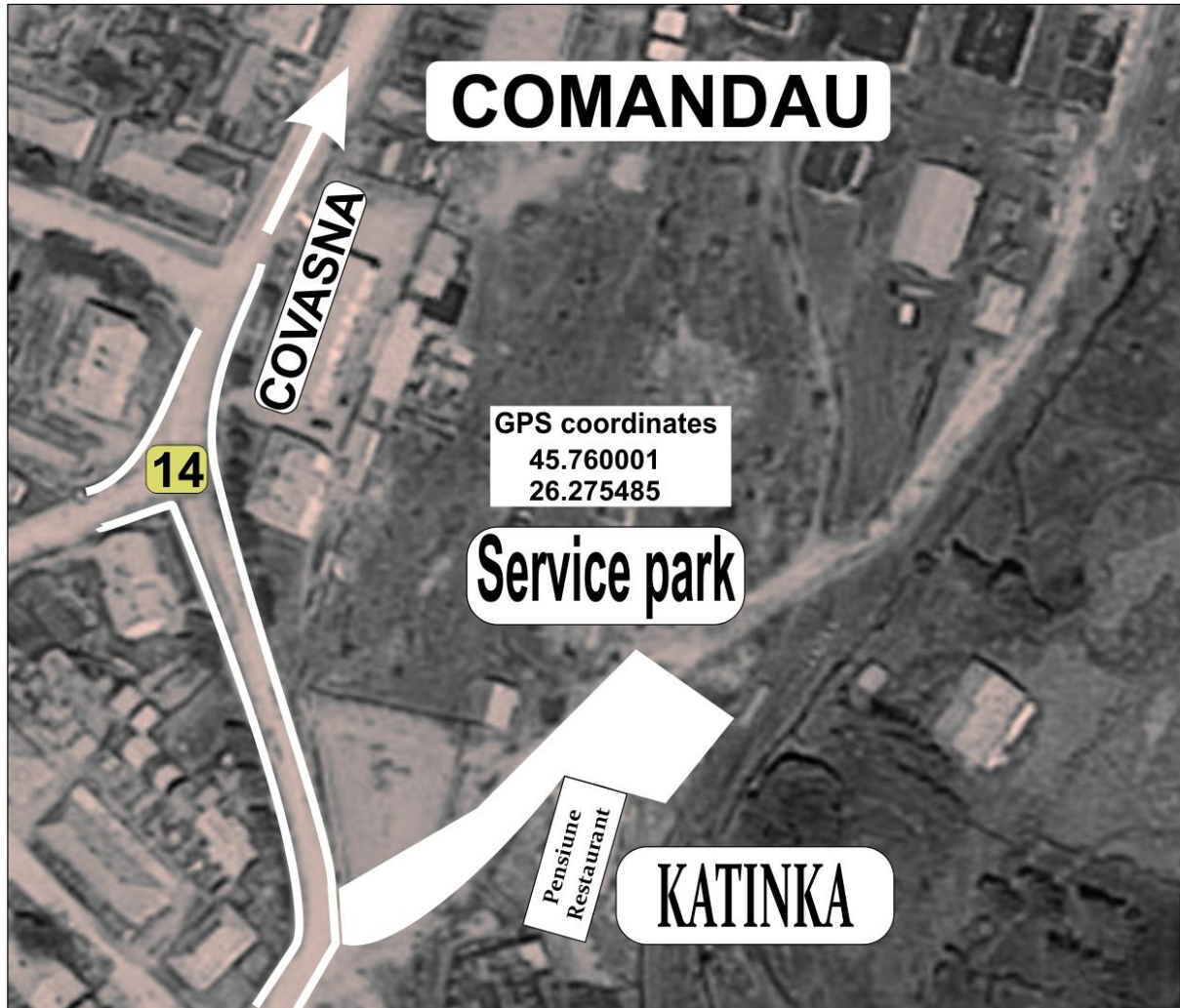

**SHAKEDOWN Declaration Form Guest**

I, undersigned, ..... born on the date of .....,  
in the locality of ....., residing in the county of .....,  
locality of ....., street ....., number  
....., building ....., entrance ....., floor....., apartment ....., owner  
of the identity card (type) ..... series ....., no. ...., issued by .....  
....., on the date of ....., personal identification number  
....., having the quality of Guest, declare having been  
informed regarding the risks I expose myself to, declare I will respect the Driver's indications and, in the  
case of an incident, will have no moral or material claims from FRAS, the Organiser, nor the Driver.

Date .....

Guest's Signature .....

